

REVISIONS		
REV. NO.	DESCRIPTION	DATE

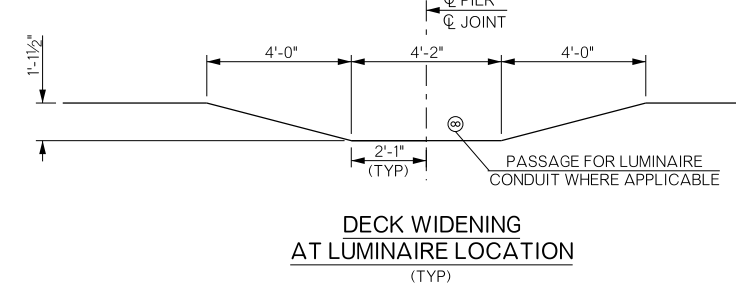
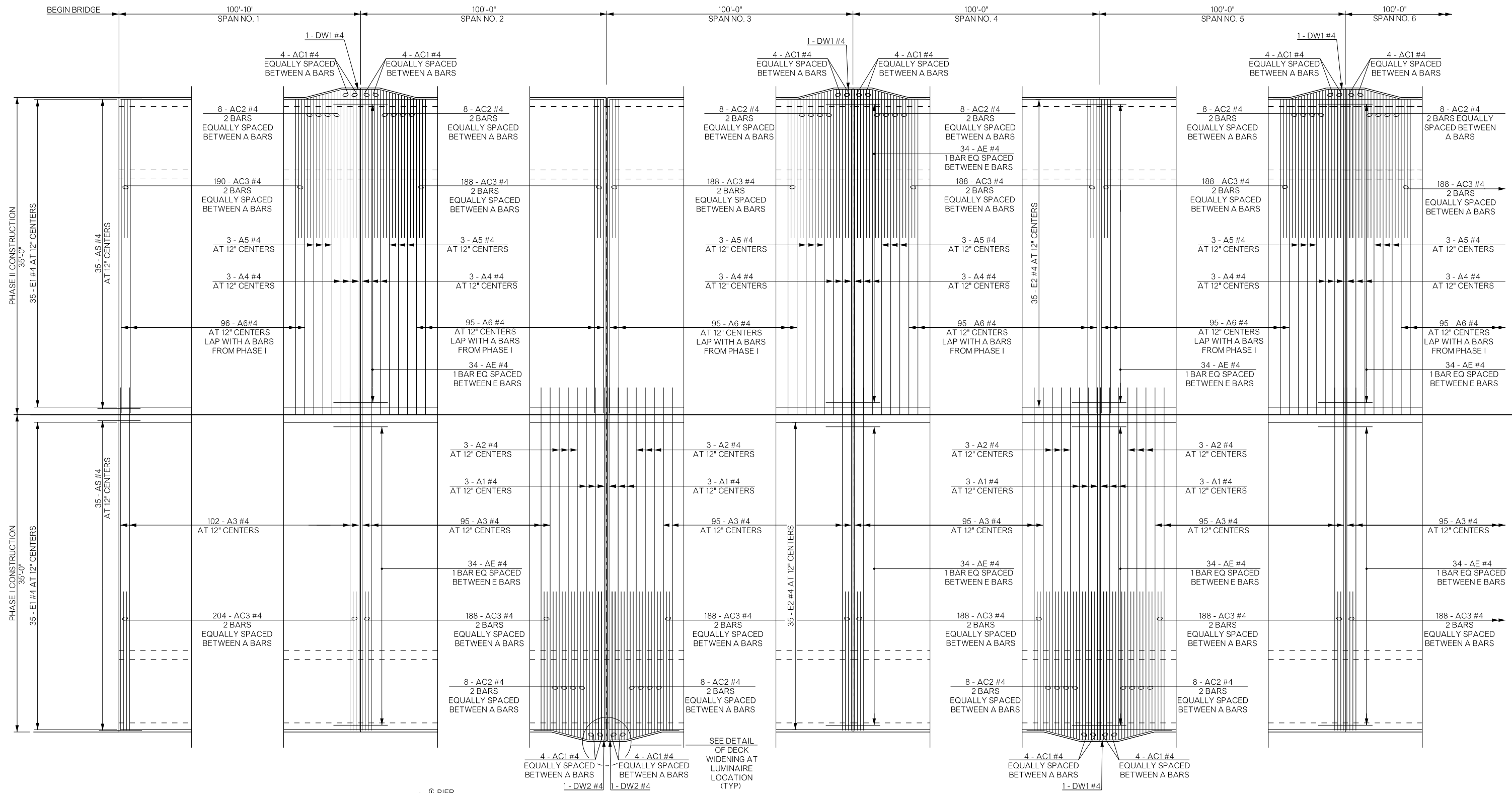

BRIDGE DECK REINFORCING TOP MAT

NOTE:
-FOR DETAILS OF LUMINAIRE MOUNT, SEE SHEET B070 AND STANDARD BMF3-2-00.

BRIDGE "A" SH-33 OVER COTTONWOOD CREEK		LOGAN COUNTY	
DETAILS OF SUPERSTRUCTURE (SHEET 6 OF 14)		Design	GT 11/15
		Detail	TIS 4/16
		Check	
		Squad	PEARSON
		Engr.	HERNANDEZ
STATE OF OKLAHOMA		DEPARTMENT OF TRANSPORTATION	
JOB/PIECE NO. 21860(04)		SHEET NO. B059	